

# LEAK DETECTION SYSTEM

Exagate Leak Detection System is a specialized solution tailored to identify and promptly alert users to leaks occurring at specific points or within designated zones. Offering seamless integration, alarm notifications, and remote management capabilities, this system provides a reliable and adaptable solution for detecting leaks in various environments. By enhancing facility safety, resilience, and operational efficiency, Exagate Leak Detection System offers peace of mind and proactive leak management.

## Why Exagate Leak Detection System?

- Modular and scalable design
- 24/7 monitoring and remote access
- Trusted in Tier III & IV data centers globally
- Industrial-grade hardware
- Seamless integration with PDU and DCIM

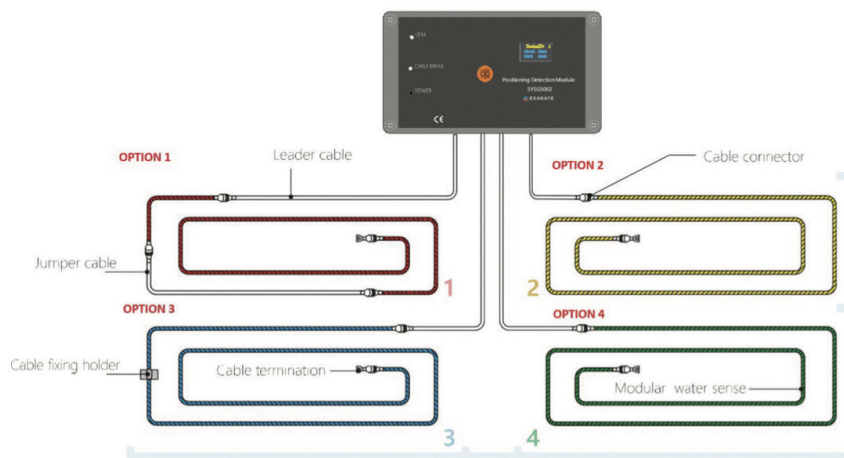

## SYSG5001 Leak Detection System Automation Panel

- 15" or 10" Industrial panel display
- 8 media graphics can be loaded
- 256 zone definition
- User friendly interface
- Internal backup power supply unit
- Redundant operation both in hardware and software



**SYSG5001 Leak Detection System Automation Panel** provides intuitive graphical visualization of leak locations and system status through a 10" or 15" industrial touchscreen display. It monitors up to 256 zones, supports multi-media graphics, and includes redundant hardware/software features and internal battery backup for high reliability.

# SYSG5002

## Positioning Detection Module



- **Positioning leak detection module.**
- **Detection cable can be** extended up to 1500m for comprehensive coverage.
- LCD screen provides real-time equipment status and precise leakage alarm positioning.
- Remote alarm and control enabled via MODBUS communication protocol for seamless integration with existing systems.
- Simple setup and operation for user convenience and efficiency.

**SYSG5002 Positioning Detection Module** supports up to 1500 meters of sensing cable and detects water and oil leaks with pinpoint accuracy. Alarm signals and real-time location information are displayed on an integrated LCD screen.

# SYSG5100

## Positioning Water Sense Cable

**SYSG5100 Positioning Water Sensing Cable** is designed to detect conductive liquid leaks anywhere along its length. It supports seamless integration with most alarm systems via dry contact or RS485 output.

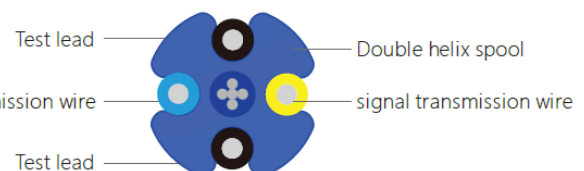
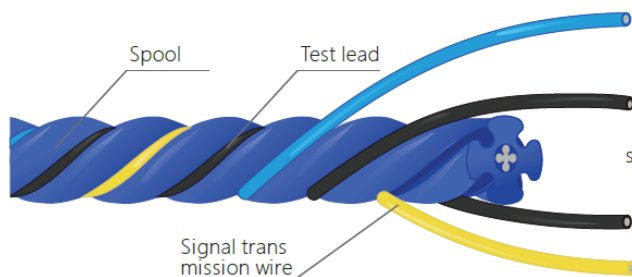

- Detection wire: conductive rubber + tinned copper wire
- Spool: Double helix spool, PE material
- Signal transmission wire: conductive rubber + tinned copper wire

# SYSG5120

## Alarm Module Zone Type



- Compact design for easy guide rail mounting in various settings.
- Total cable length of 500 meters for extensive coverage.
- One-click silence and automatic reset function for quick response and minimal downtime.
- RS485 MODBUS communication ensures seamless integration.
- Simple setup and operation enhance user convenience and efficiency.

**SYSG5120 Zone-Type Alarm Module** offers reliable zone-based leak detection using up to 500 meters of 2-core sensing cable. Compatible with various probe types and equipped with RS485 MODBUS communication, relay output, remote alarm, and control functionality.

# SYSG5090

## Zone Water Sense Cable

**SYSG5090 Zone Sensing Cable** is a durable double-helix cable designed to detect conductive liquid leaks. Its robust PE structure ensures long-term performance and ease of deployment.

### Cable structure

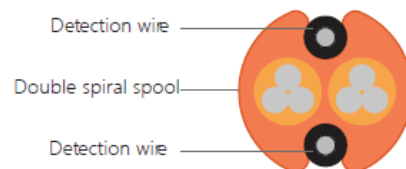
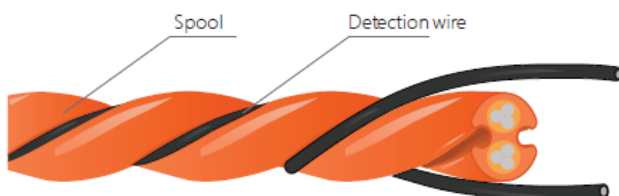

● Detection wire:  
Conductive rubber+tinned copper wire

● Spool:  
Double helix spool, PE material

● Reinforced core:  
enhanced cable strenght, no detection function

# SYS5010

## Point Type Water Immersion Sensor

- Stainless steel detection probe ensures durability and accuracy.
- Sensitivity adjustment function for customizable leak detection.
- 12-24 VDC/AC power supply for versatile installation options.
- Relay output for remote alarm control.
- RS485 or dry contact communication for seamless integration.
- Simple setup and operation enhance user convenience and efficiency.



### SYSG5010 Series – Point-Type Water Immersion Sensors

Designed for fixed-point detection, these compact, highly sensitive sensors feature adjustable detection height, optional RS485 or dry contact communication, and durable construction including stainless-steel guard options.

Suitable for standalone use or integration with Exagate's centralized monitoring systems

### Inventory List

Product Code	Description
SYSG5003	Leak Detection System Automation Panel - 10"
SYSG5001	Leak Detection System Automation Panel - 15"
SYSG5002	Positioning Detection Module
SYSG5120	Alarm Module Zone Type
SYSG5010-RS	Point Type Water Immersion Sensor With RS485
SYSG5010	Point Type Water Immersion Sensor With Dry Contact
SYSG5180	Point Type Water Immersion Sensor Plastic Casing
SYSG5190	Point Type Water Immersion Sensor Stainless-Steel Guard Plate
SYSG5100	Positioning Water Sense Cable Reel - 300 Meters
SYSG5100- 3M	Positioning Water Sense Cable - 3 Meters
SYSG5100- 5M	Positioning Water Sense Cable - 5 Meters
SYSG5100- 10M	Positioning Water Sense Cable - 10 Meters
SYSG5090	Zone Water Sense Cable Reel - 300 Meters
SYSG5090-3M	Zone Water Sense Cable - 3 Meters
SYSG5090-5M	Zone Water Sense Cable - 5 Meters
SYSG5090-10M	Zone Water Sense Cable - 10 Meters
SYSG5004-Z	Zone Leader Cable - 3 Meters
SYSG5004-P	Positioning Leader Cable - 3 Meters
SYSG5200-P	Positioning Jumper Cable Reel - 300 Meters
SYSG5200-P-3M	Positioning Jumper Cable - 3 Meters
SYSG5200-P-5M	Positioning Jumper Cable - 5 Meters
SYSG5200-P-10M	Positioning Jumper Cable - 10 Meters
SYSG5200-Z	Zone Jumper Cable Reel - 300 Meters
SYSG5200-Z-3M	Zone Jumper Cable - 3 Meters
SYSG5200-Z-5M	Zone Jumper Cable - 5 Meters
SYSG5200-Z-10M	Zone Jumper Cable - 10 Meters
SYSG5020-Z	Zone Termination Module
SYSG5020-P	Positioning Termination Module
SYSG5040	Cable Sockets
SYSG5060	Fixed Cable Holder (5 pcs)
SYSG5060 -1	Fixed Cable Holder (100 pcs)
SYSGAC13	Signal Tower with Buzzer